

1

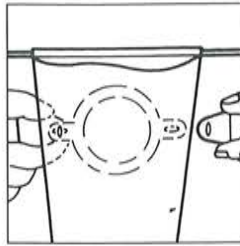

2

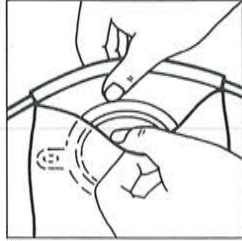

3

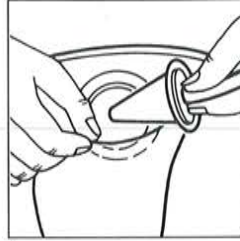

4

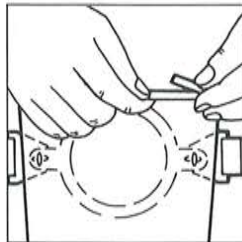

5

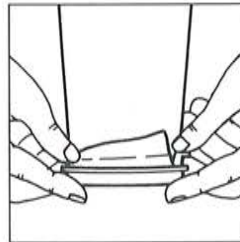

6

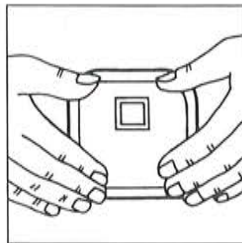

7

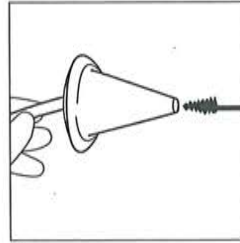

8

## US Stoma Cone Irrigator and Irrigator Drain

Routine irrigation (enema) is done on doctor's orders, to regulate emptying of the bowel at a scheduled time.

Allow up to one hour to irrigate completely.

### Directions for Application

1. Connect the stoma cone tube with the tube from the irrigator by pushing them together. Twist connectors until you feel a distinct "snap." Make sure the flow control is closed.

Fill the irrigator bag with the recommended amount of lukewarm water.

Open the flow control and let the water run through the cone to force all of the air from the tubing. Then close the flow control again. Hang the filled irrigator so the bottom is at shoulder height when seated.

2. Fasten the belt to the gasket of the drain so the button faces away from the body. Center the stoma in the middle of the gasket, wrap the belt around the body, and fasten the other end. Adjust the belt so the gasket makes a water-tight seal against the skin.

While sitting on a toilet or a chair next to the toilet, place the end of the irrigator drain into the bowl.

3. Open the irrigator drain at the top.
4. Insert the stoma cone into the stoma through the opening in the top of the drain. If desired, coat the stoma cone with Hollister Stoma Lubricant (Stock No. 7740). Press the cone against the stoma gently but hard enough to prevent leakage. Open the flow control; if water does not flow into the stoma, rotate the angle of the cone until water does flow.

To change the rate of flow, adjust the flow control. If cramping is felt, close the flow control until cramping subsides. Then open it again and let the rest of the water flow in. (The amount of water needed for proper irrigation depends on the individual and the doctor's orders, usually no more than 1,000cc.) When the irrigator bag is empty, close the flow control and remove the cone from the stoma.

5. Straighten the top strip and then roll it down and away from the body until the drain top is securely closed. Fold the ends of the strip in and pinch tightly to secure. After the first water and stool return, it usually takes from 30 to 45 minutes for the bowel to empty.
6. You may wish to move about after the initial discharge. To do so, close the drain bottom with the clamp provided.
7. When discharge is complete, remove the drain, clean the area around the stoma, and dry. Apply a pouch or stoma cap.
8. Carefully clean the cone, tubing and any other equipment that you plan to reuse. A brush is provided. **DO NOT FLUSH THE IRRIGATOR DRAIN DOWN THE TOILET.**