

# ACTIVE LIFE® CONVEX

One-piece Drainable Ostomy Pouch with Durahesive® Skin Barrier  
Bolsa Drenable de Una Pieza con Protector Cutáneo Durahesive®  
Sac pour stomie vidable d'une pièce avec barrière cutanée Durahesive®

Instructions for use  
Instrucciones de uso  
Mode d'emploi



 Convatec

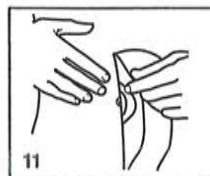
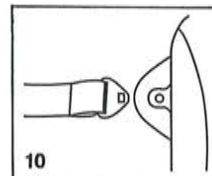
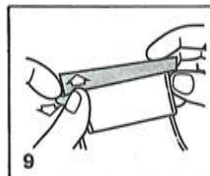
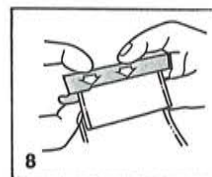
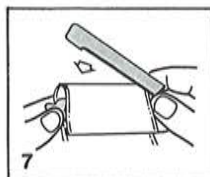
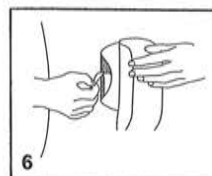
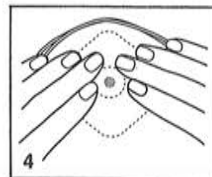
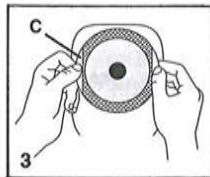
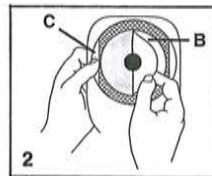
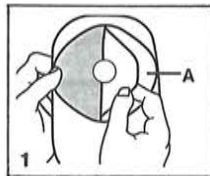

## ACTIVE LIFE® CONVEX APPLIANCES AND COMPLEMENTARY CONVATEC® PRODUCTS

### CONVEX ONE-PIECE DRAINABLE POUCH WITH DURAHESIVE® SKIN BARRIER

- 9 Precut Stoma Opening Sizes

### CONVEX ONE-PIECE UROSTOMY POUCH WITH DURAHESIVE® SKIN BARRIER

- 9 Precut Stoma Opening Sizes

### IRRIGATION EQUIPMENT

- Visi-Flow® Irrigator Set
- Visi-Flow® Cone
- Sur-Fit® Irrigation Sleeve
- Sur-Fit® Irrigation Adapter Faceplate

### STOMAHESIVE® PASTE

- 2 oz. (56 g) Tube

### STOMAHESIVE® POWDER

- 1 oz. (28 g) Bottle

### BELT

- Box of 1 belt

### ACTIVE LIFE® TAIL CLOSURE

- Box of 10 closures

### SUR-FIT® NIGHT DRAINAGE

- SET - Includes container, tubing, cover and universal adapter; box of one
- TUBING; box of one
- COVER; box of one

Convatec® offers a complete line of ostomy products. For more information on Convatec products, contact your health care professional, ostomy supply dealer, or call 1-800-422-8811 (U.S. only).

1-800-465-6302 (Canada only).

 **Convatec**

Convatec Inc.  
Skillman, NJ 08558  
1-800-422-8811

[www.convatec.com](http://www.convatec.com)

© 2008 Convatec Inc.  
®/™ indicates a trademark of Convatec Inc.

Made in USA  
1001006C1