

3777

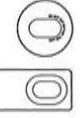

3778



1

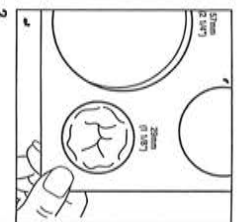

2

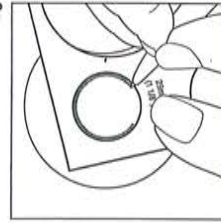

3

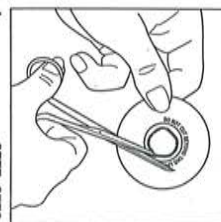

4

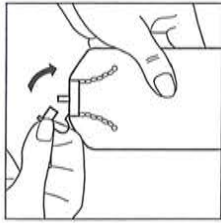

5



6

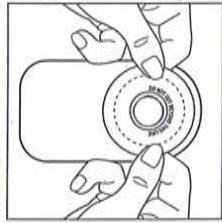

7



8

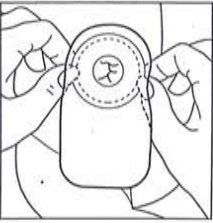

9

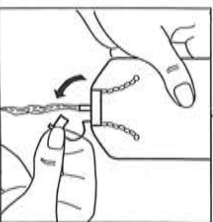

10



11

3778, 3779

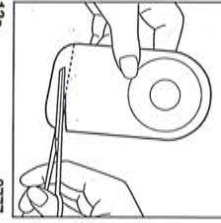

13a

3777



12

3777, 3778

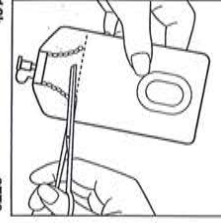

13b

3778

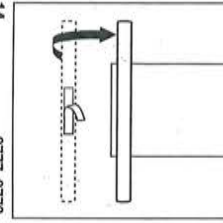

14

3777, 3778

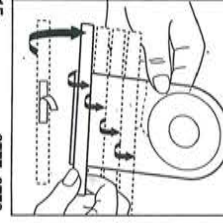

15

3777, 3778

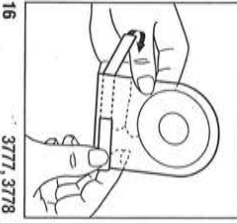

16

3777, 3778

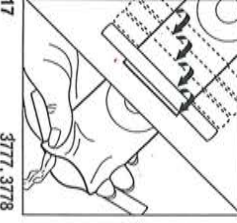

17

3777, 3778

### US Pouchkins Premie/Newborn Ostomy System

#### Instructions for Use

Make sure the skin around the stoma is clean and dry. Fig. 1. Do not use oils, baby powders or lotion-type soaps that interfere with the barrier's adhesion.

**Preparing the Pouch – Figs. 2, 3, 4**

Do not cut beyond line indicated on release paper. To avoid skin stripping, use enclosed SoftFlex® Skin Barrier.

**Closing the Newborn Pouch – Fig. 5**

**Applying the Skin Barrier to Premie or Newborn Pouch**

Peel backing from pouch, Fig. 6. Set pouch aside with adhesive facing up. With cutting guide facing up, center skin barrier on adhesive pouch, Fig. 7. Hold together for 10 seconds. Once skin barrier is placed on adhesive patch, it cannot be removed. No adhesive should be visible beyond the barrier.

**Applying the Pouch**

Peel backing from skin barrier, Fig. 8. The skin barrier should fit closely around the stoma. Gently press to ensure good contact with the skin, Fig. 9.

**Emptying the Newborn Pouch – Fig. 10**

Wipe end of pouch with a tissue. Reclose pouch per Fig. 5.

**Connecting the Newborn Pouch to Drainage Bag**

Detach cap from bottom of drain valve. Insert drain tube (Stock No. 3779) into drain valve, Fig. 11. Connect other end of tubing into a bedside receptacle.

**Removing the Pouch**

Carefully lift an edge of skin barrier and peel downward, gently pushing the skin from the barrier, Fig. 12.

**Optional: Using the Premie or Newborn Pouch with Foam-Covered Closure**

Cut off bottom of pouch at desired location, Figs. 13a, 13b. If using Newborn pouch, remove stabilizers before proceeding. To apply the foam-covered closure, remove the release paper and place the closure on the body side of the pouch about 1/4 inch from the bottom, Fig. 14. Tightly fold bottom of pouch up four times. Fold ends of closure in to secure, Figs. 15, 16.

**Emptying the Drainable Pouch with Foam-Covered Closure – Fig. 17**

Wipe end of the pouch with a tissue. Reclose pouch per Figs. 15, 16.

**Do not allow pouch to overflow. Empty when 1/3 full.**

**Do not flush down the toilet.**