

1

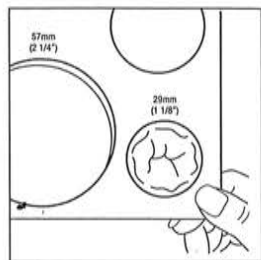

2

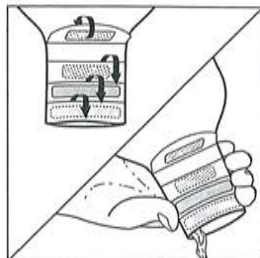

11

3795, 3796

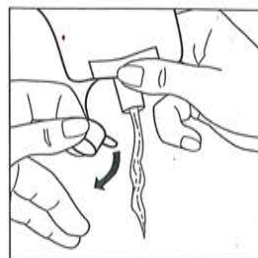

12

3797

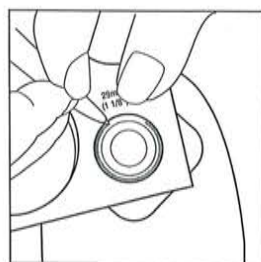

3

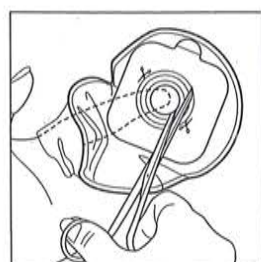

4

3795, 3796

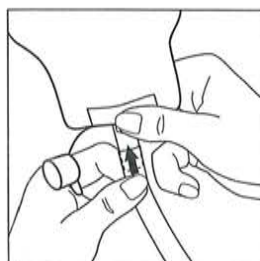

13

3797

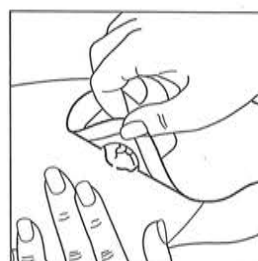

14

3795, 3796, 3797

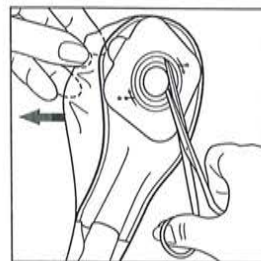

5

3797

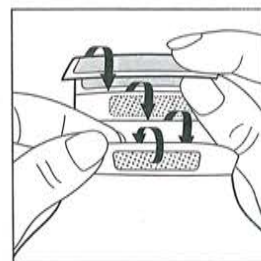

6

3795, 3796

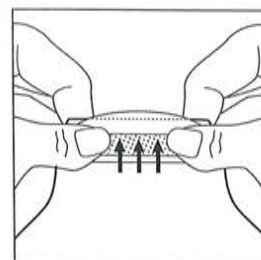

7

3795, 3796

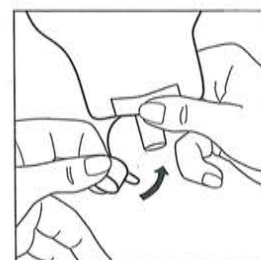

8

3797

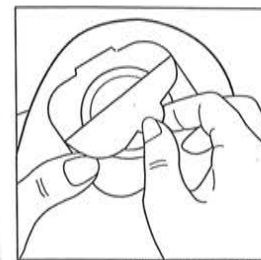

9

3795, 3796, 3797

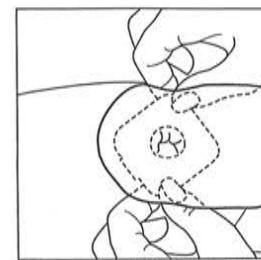

10

3795, 3796, 3797

Pouchkins Pediatric (Paediatric) One-Piece Ostomy System

Instructions for Use

Make sure the skin around the stoma is clean and dry, Fig. 1. Do not use oils, baby powders or lotion-type soaps that interfere with the barrier's adhesion.

Preparing the Pouch – Figs. 2, 3, 4, 5. Do not cut beyond line indicated on release film/paper. Be careful not to puncture pouch.

Drainable Pouch with Lock 'n Roll® Closure

Fold tail of pouch up three times, Fig. 6. Close flap and pinch to seal. Seal pouch completely, Fig. 7.

Closing the Urostomy Pouch – Fig. 8

Applying the Pouch

Peel backing from skin barrier, Fig. 9. The skin barrier should fit closely around the stoma. Gently press to ensure good contact with the skin, Fig. 10.

Emptying Pouches with Lock 'n Roll® Closure

Lift flap and unfold the pouch closure, Fig. 11. Clean inside of pouch with a tissue. Reclose pouch per, Figs. 6, 7.

Emptying the Urostomy Pouch – Fig. 12. Reclose per Fig. 8.

Connecting to Drainage Bag

Remove cap. Drain pouch. Use non-latex adapter provided in each box and connect to spout on pouch. Connect drainage bag tubing into bottom of adapter, Fig. 13.

Removing the Pouch

Carefully lift an edge of skin barrier and peel downward, gently pushing the skin from the barrier, Fig. 14.

Do not allow pouch to overfill. Empty when 1/3 full.

Do not flush down the toilet.